

SYNKRO

PÖTTINGER two and three-row stubble cultivators





Airing the soil

SYNKRO stubble cultivator
with working widths of 8.2' - 19.68' /
2.50 m – 6 m

The classic piece of equipment for conservation in soil preparation is the cultivator. The mixing in of residue from the harvest increases the fertility of the soil and protects from erosion. SYNKRO cultivators in two or three-row versions, with many and diverse rear rollers, create the ideal conditions for the germination of weeds, lost grain and break crops.

Our compact two-row series operates smoothly with a low power requirement. A frame height of 31.49" / 800 mm guarantees you trouble-free operation.

SYNKRO three-row stubble cultivators are ideal for shallow stubble work and deep tillage. A central adjustment system allows you to adjust the working depth quickly and easily.

Contents

	Page
Two-row mounted cultivators	4 – 9
Three-row mounted cultivators	10 – 19
SYNKRO MULTILINE system	20 – 23
Three-row trailed cultivators	24 – 27
Rear rollers	28 – 31
Technical data	32 – 33
Standard & Optional Equipment	34 – 35

All information on technical data, dimensions, weights, output, etc.
is approximate and is not binding.



SYNKRO 1020 range

Two-row stubble cultivators – light and compact



These low draft and compact two-row cultivators are designed for lighter weight tractors with lower lifting capacity.

Adjustable headstock

The angle of the SYNKRO headstock is adjustable and this enables an ideal match to your tractor. This optimized hitching geometry improves ground clearance on headland turns and during transport.

- Two lower linkage positions.
- Four top link positions.
- As a result the cultivator can be adapted to all sizes of tractor.

Compact frame

The compact frame is a trademark of the SYNKRO 1020 series. The first row of tines is very close to the tractor for a very favourable centre of gravity.

- The 3.93 x 3.93" / 100 x 100 mm fine-grained steel frame box section provides the highest strength.
- 29.52" / 750 mm row spacing and 31.49" / 800 mm frame height guarantee maximum clearance.
- The tapered frame design directs the tractor's pulling power from the lower linkages directly to the rear roller mountings.



SYNKRO 1020 range

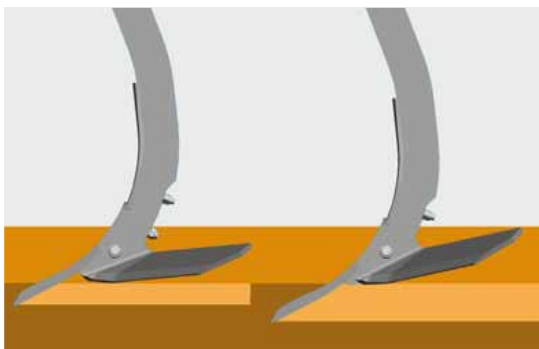

Durable tines and shares

The tine legs have been engineered to form an arc for a perfect working angle. The mounting brackets reach right down the leg to provide a high level of strength and stability.

Fitted with a shearbolt each tine offers three positions for reliable penetration and uniform surface mixing.

Proven on all types of soil

- The two-row SYNKROs are equipped as standard with split chisel points and wide wing shares.
- With a tine spacing of 16.53 to 18.11" / 42 to 460 mm, all the soil is moved right through.
- Slightly curved shins ensure intensive mixing. The outer tines are fitted with fully curved shins.
- Optionally PÖTTINGER offers double diamond points with wings in lieu of chisel points and shins.

Two-position wing shares

For very shallow or deep cultivation the cultivator points and wings ensure thorough mixing of the soil. Being able to adjust the height and angle of the wings ensures optimum penetration and excellent mixing performance.

Shallow point – deep and flat wings

Less aggressive penetration – smoother soil surface

Deep point – higher and steeper wings

More aggressive penetration, enters soil easier – better mixing effect



Perfect results

Because the wing shares overlap, the whole area of soil is cultivated thoroughly on both the deep and very shallow settings. Unique working results are achieved with the shallow setting thanks to the low penetration depth. Only PÖTTINGER stubble cultivators manage to produce such a perfectly level result.



Cultivate longer with DURASTAR points and wings

- Double the durability compared to standard points.
- High quality coating on the front side of the point.
- High tungsten-carbide content for longer service life.
- Resistant to wear even in stony conditions.
- Special point shape with higher volume in the area subject to most wear

Seriously tough.

- Coated on the underside of the wing.
- Double the durability compared to standard wing share.
- Much higher wear resistance thanks to high quality steel that retains tine shape.
- Coating even withstands stone impact.

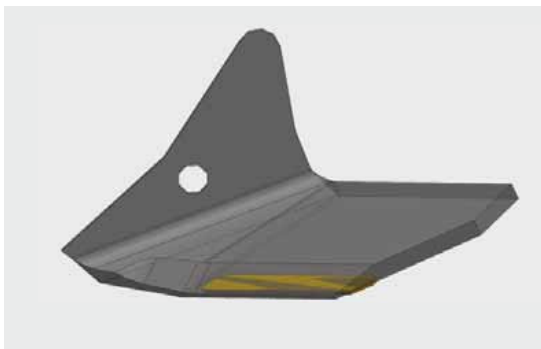



Easy adjustment

Working depth is adjusted quickly and easily at the rear roller. Thanks to the tapered frame, the pin-in-hole system is easily accessible on both sides without risk to the operator.

- Only one adjustment point on each side.
- The rear roller is secured in place to transfer additional weight to the cultivator and improve penetration.



Proven components

The levelling discs are guided by the rear roller and adjusted together in parallel; they can also be depth-adjusted in pairs. Scalloped profile for even better performance. Levelling tines are also available as an option in lieu of the discs.

Optional edging boards adjust automatically to the working depth to prevent ridges forming. They are spring-mounted to enable sideways movement. These can be folded inwards on rigid-frame SYNKRO cultivators to reduce transport width.



SYNKRO NOVA

Spring-mounted tines on the SYNKRO NOVA guarantee NONSTOP cultivation in stony soil.

- Two tine positions for reliable ground penetration.
- The levelling discs are protected by rubber elements.
- Additionally the tines are also protected by shear bolts.



The wide models are foldable

SYNKRO 4020 K / 5020 K / 6020 K

The mounted cultivators with working widths of 13.12' / 4.0 m to 19.68' / 6.0 m can be folded vertically for road transport. The cultivators are folded in two halves to achieve a low transport height. A safety interlock engages automatically using hydraulically activated lock pin. Two 10/75-15,3 front support wheels are available to provide ground contour following. Depth is adjusted using a ratchet turnbuckle each side.





SYNKRO 1030 range

Three-row cultivators



The three-row SYNKRO 1030 cultivators are ideal for shallow and deep stubble cultivation with tractors from 100 hp upwards. They offer technical solutions for even more efficient operation and convenient adjustment.

Rigid-framed mounted cultivators

SYNKRO 3030 / SYNKRO 3530

The compact frame is a trademark of the mounted stubble cultivators. The first row of tines is very close to the tractor for a very favourable centre of gravity.



Folding mounted cultivators

SYNKRO 4030 K / SYNKRO 5030 K

The foldable mounted stubble cultivators can be folded upwards for road transport so that they are within 9.84' / 3.0 m and still have a low transport height. The folding system is equipped with an automatic hydraulic transport interlock.



Foldable trailed cultivators

SYNKRO 4030 T / SYNKRO 5030 T / SYNKRO 6030 T

The transport chassis ensures that the hitch and rear axle of the tractor are not overloaded. The cultivators are folded in two halves and the chassis is wide with a low centre of gravity for excellent driving stability. It also can be lowered for road transport.



Moving the whole surface, perfect mixing in and excellent crumbling are what make SYNKRO stubble cultivators so popular with users. SYNKROs feature proven point and wing share geometry for uniform working in and intensive mixing of harvest residues, slurry, muck and mulch.

Proven point and wing share geometry

The three-row SYNKROs are equipped with split chisel points and wing shares as standard. The narrow tine spacing of either 10.62 or 11.02" / 270 or 280 mm ensures optimum mixing of harvest residues – an ideal prerequisite for mulch drilling.

- The slightly curved shins mix the flow of soil from the side – an intensive rolling movement without flinging soil up into the frame.
- The outer tines are fitted with curved edging shins.
- Optionally, PÖTTINGER offers double diamond tines with wings or a quick change point system.

For deep loosening work down to 11.81" / 300 mm, you can choose between chisel points, double-diamond points on their own or narrow points with a quick-change system.

The wings can be removed by removing just one bolt on each leg.



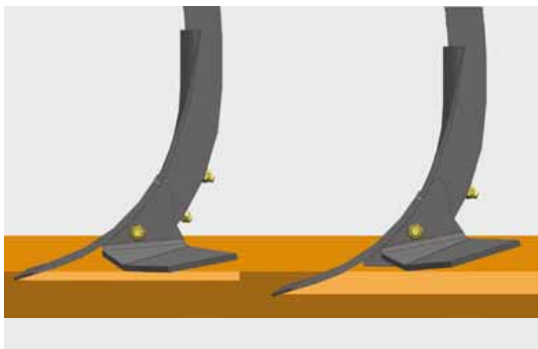

Two-position tines

For very shallow or deep cultivation

The cultivator points and wings ensure thorough mixing of the soil. Being able to adjust the height and angle of the wings ensures optimum penetration and excellent mixing performance.

The position of the legs can be shifted by undoing just one bolt on each leg.

Shallow point – wide and flat wings

Less penetration – smoother soil surface

Deep point – higher and steeper wings

Increased penetration, enters soil easier – better mixing effect

Optimum setting

Together with the shins, the curved legs ensure optimum soil flow.

The tines are fitted with shear bolts as standard. There is a range of settings for matching penetration performance to the operating conditions, even on dry and hard ground.

- SYNKRO standard: Three positions
- SYNKRO NOVA: Two positions



NONSTOP stubble cultivation

SYNKRO NOVA models are equipped with overload protection. PÖTTINGER has completely updated the NOVA stone protection system and it now features a newly-developed horizontal spring unit. When obstacles are met, uninterrupted working is guaranteed by safe tripping and the large movement arc.

- The triggering force of 1212 lbs / 550 kg diminishes as the leg is raised – stones are not pulled up or loosened. This protects both the cultivator and the tractor.
- On the SYNKRO NOVA the first row of tines is located as far forward as possible to bring the weight as close as possible to the tractor.
- Two tine positions for reliable penetration.
- Additionally the tines are also protected by a shearbolt.

Maintenance-free, rubber-mounted levelling discs

The levelling discs on the SYNKRO NOVA are also equipped with maintenance-free overload protection.

- Proven over many years in the field, the maintenance-free NON STOP trip protection system features 1.57" / 40 mm-thick rubber elements.
- The sealed bearings are maintenance-free and do not need to be lubricated.
- A labyrinth seal provides perfect protection for the bearing.

Levelling tines are also available as an option in lieu of the discs.

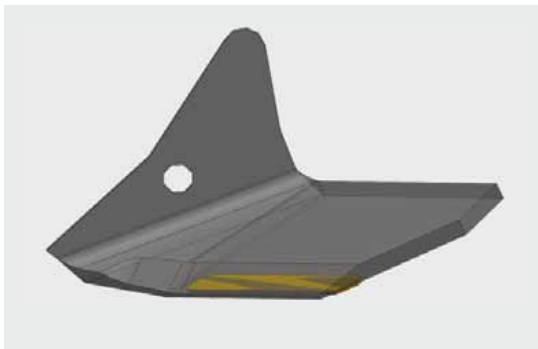

Cultivate longer with DURASTAR

Proven on all types of soil

SYNKRO tine points and wings ensure thorough mixing of the soil thanks to their adjustable position. The rate of wear of the tines depends on driving speed and the type of soil. Sandy and stony soil subject implements to the highest rate of wear. DURASTAR coatings extend the service life of tools considerably.

Cultivator chisel points and wings

- Double the durability compared to standard points.
- High quality coating on the front side of the point.
- High tungsten-carbide content for longer service life.
- Resistant to wear even in stony conditions.
- Special point shape with higher volume in the area subject to most wear.

DURASTAR PLUS points NEW

- High quality base material and hardened metal for the points
- Much longer service life and higher resistance to fracture for top reliability
- Up to six times more durable – saving costs and time
- Improved penetration, lower power required thanks to optimised leading edge
- Optimum loosening and mixing through of soil

Seriously tough

- Coated on the underside of the wing.
- Double the durability compared to standard share.
- Much higher wear resistance thanks to high quality base material that retains tine shape.
- Coating even withstands stone impact.



SYNKRO 1030

SYNKRO 1030 K

Three-row mounted cultivators



Adjustable headstock

Tractors with up to 190 hp have a huge range of hitch geometries. The range of mounting options offered by the headstock ensures excellent ground penetration and sufficient transport height.

SYNKRO 3030 / SYNKRO 3530

Two lower linkage mounting heights with clevis-type mounting lugs. The headstock angle can be adjusted and with three top linkage positions optimum adaptation to any tractor is guaranteed.

- Headstock vertical – standard position.
- Headstock angled forward for tractors with short top links.
- Headstock offers lower mountings for smaller tractors.

SYNKRO 4030 K / SYNKRO 5030 K

On the foldable models, the headstock provides three top link and two lower linkage mounting heights.

HEAVY DUTY frame

The compact frame is a trademark of mounted SYNKRO stubble cultivators. The first row of tines is very close to the tractor for a very favourable centre of gravity.

- 3.93 x 3.93" / 100 x 100 mm box section frame made from fine-grained steel gives the greatest stability.
- With longitudinal beams configured in a taper, the tractor's pulling power is transferred from the lower linkages directly to the rear roller mountings.
- Thanks to the tapered frame the depth adjustment system is easily accessible on both sides without risk to the operator.



Ingenious setting system

The depth adjustment system for the rear roller enables the working depth to be adjusted quickly and easily using a straightforward pin-in-hole system.

- Only one adjustment point at the front on each side – even on folding cultivators.
- The position of the rear roller is locked to provide additional transfer of weight from the rear roller to the stubble cultivator.



Maintenance-free levelling discs

Scalloped levelling discs are guided by the rear roller and adjusted together in parallel; they can also be depth-adjusted in pairs. A six-lip labyrinth seal provides completely tight protection for the bearings. The bearing is therefore maintenance-free; no complicated work required.



Edging boards

The optional edging boards are mounted right next to the outer tines to prevent ridges forming. The edging boards adjust automatically to the working depth and are spring-mounted to enable sideways movement. These can be folded inwards on rigid-frame SYNKRO cultivators to reduce transport width.



Levelling tines

The levelling tines are a lighter and cost-effective alternative to levelling discs. These are ideal for use in moderate amounts of harvest residues and finely chopped straw.

- Available for all three-point linkage mounted SYNKROs
- Individually suspended tines
- Height and inclination adjustment



Rear harrow

Optional for three-point linkage mounted SYNKROs. The rear harrow leaves a finely-crumbled surface. The ridges created by rear rollers is levelled to prevent ponding. Harvest residues are placed lightly on the surface to provide ideal germination conditions for weeds and volunteers. Available with knife ring roller, pack ring roller, rubber-packer roller and conical ring roller.



DRILLBOX

Catch crop seed drill for SYNKRO 2520, SYNKRO 3020 and SYNKRO 3030

- Main adjustment with a lever, fine adjustment with a screw adjustor.
- Scattering plates for even distribution.
- Optional agitating shaft for seed mixtures.
- Driven by land wheel.
- Catchment tray for calibration.



SYNKRO 3030 MULTILINE

Extend the range of applications on your SYNKRO 3030



PÖTTINGER's MULTILINE concept creates a true all-rounder for arable professionals. By combining a trailed SYNKRO 3030 with an implement-mounted VITASEM seed drill, you gain maximum flexibility and cost effectiveness.

Combining a SYNKRO stubble cultivator with a VITASEM seed drill provides the basis for high-performance and cost-effective mulch drilling technology. The VITASEM implement-mounted drill can also be used in combination with a TERRADISC disc harrow, LION power harrow or FOX compact combination.



Working cost-effectively

Moreover, trailed SYNKRO models can also be used on their own for shallow or deep soil cultivation. This allows high output to be achieved with smaller tractors.



Flexible all-rounder

The VITASEM seed drill can be mounted on the rubber-packer roller quickly and easily. You can therefore use the SYNKRO MULTILINE at any time on its own for stubble cultivation or seedbed preparation. This turns the SYNKRO MULTILINE into a high-performance all-rounder for a wide range of applications.



Trailed tillage implements

The SYNKRO MULTILINE is a trailed implement. This means that the load acting on the rear axle of the tractor is minimised. At headlands and during transport, the unit is lifted on the rubber packer roller. This ensures smooth running, high ground clearance, and low soil compaction at headlands.



MULTILINE hitch connection

- Drawbar connects to Cat. II lower linkage.
- Lifted on rubber-packer roller.
- 11.02" / 280 mm ground clearance.
- The MULTILINE combination is raised and lowered using a double-acting connection.
- Two check valves on the drawbar ensure safe road transport.



Rubber packer roller

At the headland and during transport, the SYNKRO MULTILINE is lifted by the rubber-packer roller so the weight is distributed over the whole working width.

The roller ensures excellent stability on the road.





Straightforward and compact

VITASEM A or VITASEM ADD seed drills are mounted as standard above the packer roller. This allows the seed drill to be fitted or removed easily – depending on whether the SYNKRO is to be used on its own or not. As a result, the MULTILINE combination is a real multi-talent with a wide range of applications.

From stubble cultivation to mulch drilling

- Reverse under the seed drill and lift the support arms.
- Insert retention pins to secure seed drill.
- Connect top link between cultivator and seed drill.
- Plug in the cable for lighting and metering drive.
- Remove parking stands from seed drill.

Within just a few minutes, the trailed stubble cultivator becomes an efficient, fully-functional mulch seed drill. The MULTILINE concept offers arable farmers a wide range of combination possibilities, meeting the demands of the market.

When you purchase a SYNKRO 3030 MULTILINE, all combination options remain open so the configuration can be changed later if needed. An existing 102 series VITASEM implement-mounted seed drill can easily be integrated into the MULTILINE concept.



SYNKRO T

Three-row trailed cultivators



The transport chassis ensures that the hitch and rear axle of the tractor are not overloaded. The chassis is wide with a low centre of gravity for excellent driving stability and it can be lowered for road transport. The automatic transport interlocks also contribute to safety on the road.

For high output

SYNKRO 4030 T / SYNKRO 5030 T / SYNKRO 6030 T

The transport chassis is raised during operation in the field. This exerts extra load on the tines. Reliable penetration is therefore guaranteed on heavy, dry and hard ground.

On the trailed stubble cultivators, the sturdy longitudinal beams are also tapered towards the headstock. Perfect power transfer across the entire working width.

The cultivators are folded in two halves to achieve a low transport height. The transport interlock system engages and disengages automatically using a hydraulic cylinder and locking pin.





Performance and convenience

Working depth is easily adjusted using a pin-in-hole system on either side of the implement. Access is easy and risk -free.

- Only one adjustment point at the front on each side – even on trailed cultivators.
- The position of the rear roller is locked to provide additional transfer of weight from the rear roller to the stubble cultivator.



Practical drawbar

The drawbar is mounted on the standard headstock. The adjustable top link allows a perfect match to the tractor. Optimum ground clearance at headlands and during transport is ensured.

The lower linkage mounting yoke features Cat. 3, width 2 or Cat. 3, width 3 clevis-type lugs. Cat. 4 is available as an option. A telescopic drawbar with various connections is also available. A steering angle of up to 95° is possible with an overall tractor width of 9.84' / 4.20 m. Hose holders and parking stands come as standard.



Support wheels for consistent depth

Two 260/70-15.3 front support wheels are available to provide ground contour following. Depth is adjusted using a ratchet turnbuckle each side.



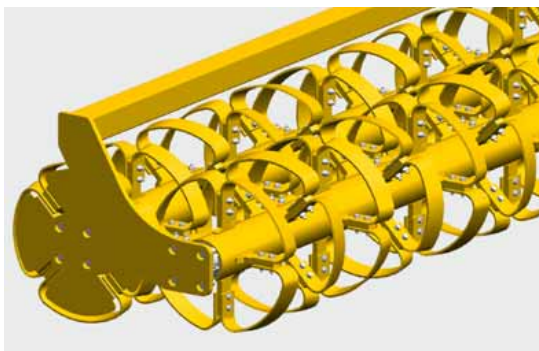

Generously dimensioned chassis

The chassis is mounted at the rear with supports through to the headstock. Perfect adjustment for the rear roller and plenty of lifting height are guaranteed.

500/45-17 tyres are standard, while for softer ground 550/45-22.5 tyres are also available.

Safe on the move

Air brakes or hydraulic brakes are also available to provide enhanced safety at driving speeds up to the legal limit. A hand brake is provided for safe parking.

Rear rollers

The choice of rear rollers for trailed machinery includes a cage roller, double cage roller, pack ring roller, tandem CONOROLL and rubber packer roller.

Tandem CONOROLL roller

The tandem CONOROLL consists of 2 rollers with strip thickness of 8 mm. The diameter of the rings is 22.04" / 560 mm. Ideal for trailed SYNKROs.

The rollers overlap each other and each has a footprint of 50 % of the working width. This works well on light soil.

- The inclination of the roller can be quickly adjusted using a pin-in-hole matrix to allow for the working depth and operating conditions.
- No scrapers required; rollers self-clean effectively.
- Raised on rear roller at headlands, so there are no problems driving backwards.
- Side-mounted edging boards guarantee smooth operation in harvest residues and stony areas



Rear rollers

For perfect results

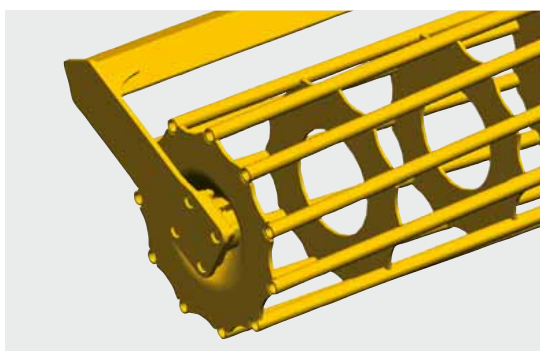

It's your choice. PÖTTINGER offers a wide range of rear rollers for perfect results with the desired tilth in any type of soil. The whole range of rollers features precision manufacturing and robust design engineering.

Cage roller

The ideal roller for dealing with dry, non-sticky soils. The roller is fitted with strong bars for optimal compression.

Diameter 21.25" / 540 mm, 11 bars;

Diameter 25.98" / 660 mm, 12 bars.

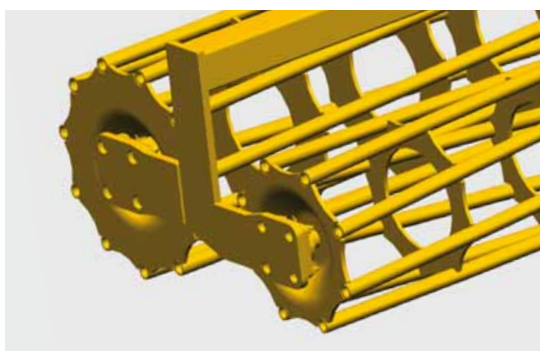

Double cage roller

The double cage roller is fitted with two different diameter rollers (21.25" / 540 mm front and 16.53" / 420 mm rear). The pendular function ensures optimum ground tracking and perfect tilth.

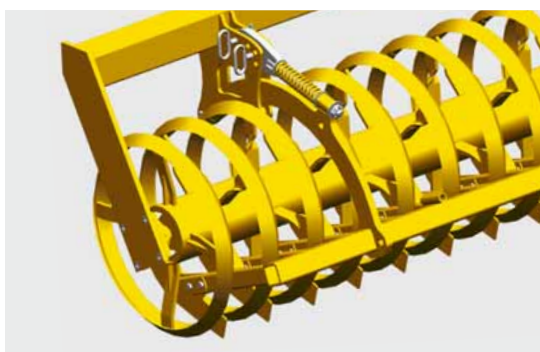

Knife ring roller

The advantages of the cutting ring roller with a diameter of 21.25" / 540 mm include enhanced crumbling and re-consolidating by means of wedge-shaped rings. The knives between the rings break up clods and keep the rings clean. Compression in strips has the advantage that water can be absorbed better. The right choice if you are working on dry and heavy soil with no rocks or stones.



Pack ring roller

The packer rings, which are closed on the sides, have a diameter of 21.65" / 550 mm. There are eight rings per metre of working width. The roller leaves consolidated ridges, promoting drainage and soil respiration. The ideal roller on stony, damp ground with large quantities of organic matter.

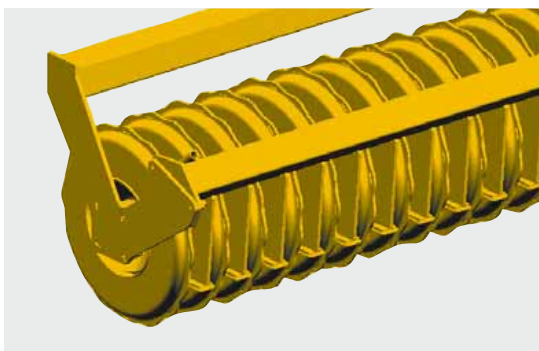

Rubber packer roller

The perfect roller for widely varied soil conditions. Especially for use with trailed implements where the load-bearing capacity of other rollers is near the limit. A diameter of 23.22" / 590 mm and the special profiling allows the soil to be compacted in rows.

MULTILINE rubber packer roller

At headlands and during transport, the stubble cultivator is lifted on the rubber packer roller. The diameter of 23.03" / 585 mm ensures excellent stability and a smooth ride on the road. The seed drill can easily be removed and refitted if the stubble cultivator needs to be used on its own.

- Less compaction at headlands.
- Resistant to wear, even on the road.
- Formation and re-consolidation of the seed slot with a row spacing of 4.92" / 125 mm.

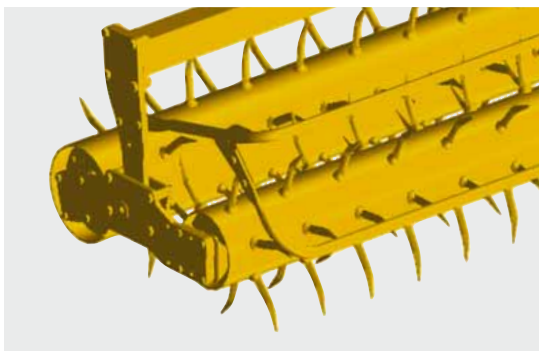

Rotopack roller

Rotopack rollers mix particularly intensively – for light to heavy, non-sticky soils. Harvest residues remain on the surface of the soil and protect your soil against drying out. Working width 9.84' / 3.0 m.

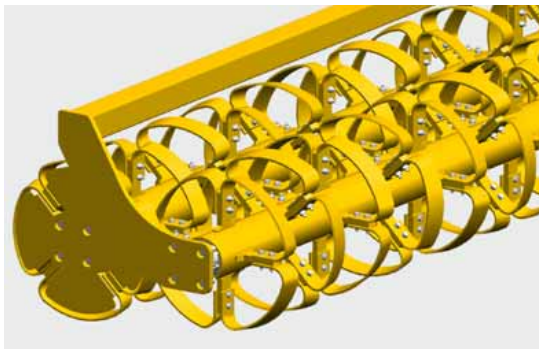
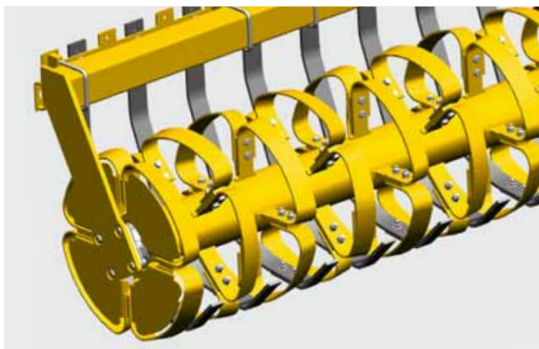

CONOROLL roller

This roller consists of rings with a diameter of 21.25" / 540 mm. Each ring is made up of four conical segments that are offset to the left and right. The result is a slot with alternate indentations on either side. When rainwater seeps into these indentations, they prevent it from flowing away.

The gap between each ring is 5.90" / 150 mm. Spring-mounted scrapers are located in between. These promote the formation of a fine tilth while keeping the space between the rings clean. The load-bearing capacity of the conical ring roller is limited on very light soil.

This is an ideal roller for medium to heavy soils. You can also use it in harvest residues no problem.

Tandem CONOROLL roller

The tandem CONOROLL consists of 2 rollers. The diameter of the rings is 22.04" / 560 mm, strip thickness 0.31" / 8 mm. Ideally suited to trailed machines.

- The rollers overlap. Each has a footprint of 50% of the working width. Works well on light soil.
- The inclination of the roller can be adjusted to allow for the working depth and conditions.
- Rollers self-clean effectively, no scrapers required. No problems driving backwards.



SYNKRO / SYNKRO NOVA	2520	3020	4020 K	5020 K	6020 K
Linkage	Cat. 2 / 2	Cat. 2 / 2	Cat. 3 / 3	Cat. 3 / 3	Cat. 3 / 3
Working width, ft / m	8.20 / 2.5	9.84 / 3.0	13.12 / 4.0	16.40 / 5.0	19.68 / 6.0
Transport width, ft / m	8.20 / 2.5	9.84' / 3.0	9.84 / 3.0	9.84 / 3.0	9.84 / 3.0
Tines	6	7	9	11	13
Levelling discs	5	6	9	10	12
Tine spacing, inch / mm	16.73 / 425	16.53 / 420	17.32/ 440	17.71/ 450	18.11 / 460
Frame section, inch / mm	3.93 x 3.93 / 100 x 100				
Row spacing, inch / mm	29.52 / 750				
Frame height, inch / mm	31.49 / 800				
Power requirement from kW / hp	51 / 70	66 / 90	103 / 140	110 / 150	129 / 175
SYNKRO base weight, lbs / kg	1521 / 690	1753 / 795	3042 / 1380	3869 / 1755	4597 / 2085
NOVA base weight, lbs / kg	2050 / 930	2315 / 1050	3737 / 1695	4696 / 2130	5181 / 2350

SYNKRO rear roller lbs / kg	2520	3020	4020 K	5020 K	6020 K
Cage roller, 21.26 inch / 540 mm	617 / 280	716 / 325	1058 / 480	1365 / 619	1499 / 680
Cage roller, 25.98 inch / 660 mm	699 / 317	937 / 425	1345 / 610	1689 / 766	1874 / 850
Double cage roller	–	–	–	–	–
Knife ring roller	794 / 360	926 / 420	1345 / 610	1587 / 720	1852 / 840
Pack ring roller	1102 / 500	1312 / 595	1808 / 820	2227 / 1010	2623 / 1190
Rubber packer roller	1113 / 505	1234 / 560	–	2204 / 1000	2469 / 1120
CONOROLL roller	816 / 370	948 / 430	1367 / 620	1631 / 740	1896 / 860
Tandem CONOROLL roller	–	1510 / 685	1294 / 950	2557 / 1160	3020 / 1370
ROTOPACK roller	–	881 / 400	–	–	–



3030	3530	4030 K	4030 T	5030 K	5030 T	6030 T
Cat. 2 / 2	Cat. 2 / 2	Cat. 3 / 2 / 3	Cat. 3 / 2 / 3	Cat. 3 / 2 / 3	Cat. 3 / 2 / 3	Cat. 3 / 2 / 3
9.84 / 3.0	11.48 / 3.50	13.12 / 4.0	13.12 / 4.0	16.40 / 5.0	16.40 / 5.0	19.68 / 6.0
9.84 / 3.0	11.48 / 3.50	9.84 / 3.0	9.84 / 3.0	9.84 / 3.0	9.84 / 3.0	9.84 / 3.0
11	12	14	14	18	18	22
6	7	8	8	11	11	13
10.62 / 270	11.02 / 280	11.02 / 280	11.02 / 280	11.02 / 280	11.02 / 280	10.62 / 270
			3.93 x 3.93 / 100 x 100			
			29.52 / 750			
			33.46 / 850			
80 / 110	96 / 130	110 / 150	110 / 150	132 / 180	132 / 180	155 / 210
2249 / 1020	2557 / 1160	4023 / 1825	6239 / 2830	5489 / 2490	8113 / 3680	8355 / 3790
3064 / 1390	3395 / 1540	5192 / 2355	7286 / 3305	6790 / 3080	9436 / 4280	10251 / 4650
3030	3530	4030 K	4030 T	5030 K	5030 T	6030 T
716 / 325	–	1058 / 480	–	1365 / 619	–	–
937 / 425	–	1345 / 610	1345 / 610	1689 / 766	1689 / 766	1874 / 850
1146 / 520	–	1675 / 760	7914 / 760	1940 / 880	1540 / 880	2293 / 1040
926 / 420	1036 / 470	1345 / 610	–	1587 / 720	–	–
1312 / 595	1565 / 710	1808 / 820	1808 / 820	2227 / 1010	2227 / 1010	2623 / 1190
1234 / 560	–	–	–	2204 / 1000	2204 / 1000	2469 / 1120
948 / 430	1124 / 510	1367 / 620	–	1631 / 740	–	–
1510 / 685	–	1294 / 950	1294 / 950	2557 / 1160	2557 / 1160	3020 / 1370
881 / 400	–	–	–	–	–	–

Standard & Optional Equipment



Double-diamond share with goose wing

DURASTAR chisel point

DURASTAR chisel point with armoured wings

Edging plate left/right

SYNKRO 2520	<input type="checkbox"/>	<input type="checkbox"/>	<input type="checkbox"/>	<input type="checkbox"/>
SYNKRO 3020	<input type="checkbox"/>	<input type="checkbox"/>	<input type="checkbox"/>	<input type="checkbox"/>
SYNKRO 4020 K	<input type="checkbox"/>	<input type="checkbox"/>	<input type="checkbox"/>	<input type="checkbox"/>
SYNKRO 5020 K	<input type="checkbox"/>	<input type="checkbox"/>	<input type="checkbox"/>	<input type="checkbox"/>
SYNKRO 6020 K	<input type="checkbox"/>	<input type="checkbox"/>	<input type="checkbox"/>	<input type="checkbox"/>



Double-diamond share with goose wing

DURASTAR chisel point

DURASTAR chisel point with armoured wings

Edging plate left/right

SYNKRO 3030	<input type="checkbox"/>	<input type="checkbox"/>	<input type="checkbox"/>	<input type="checkbox"/>
SYNKRO 3530	<input type="checkbox"/>	<input type="checkbox"/>	<input type="checkbox"/>	<input type="checkbox"/>
SYNKRO 4030 K	<input type="checkbox"/>	<input type="checkbox"/>	<input type="checkbox"/>	<input type="checkbox"/>
SYNKRO 5030 K	<input type="checkbox"/>	<input type="checkbox"/>	<input type="checkbox"/>	<input type="checkbox"/>
SYNKRO 4030 T	<input type="checkbox"/>	<input type="checkbox"/>	<input type="checkbox"/>	<input type="checkbox"/>
SYNKRO 5030 T	<input type="checkbox"/>	<input type="checkbox"/>	<input type="checkbox"/>	<input type="checkbox"/>
SYNKRO 6030 T	<input type="checkbox"/>	<input type="checkbox"/>	<input type="checkbox"/>	<input type="checkbox"/>

■ = Standard, □ = Optional

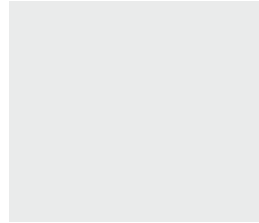
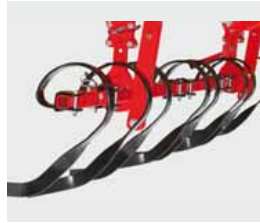

Rear harrow

Levelling tines

**Depth wheels
10/75-15.3**

Tine protection

**Warning signs
with Lighting**

<input type="checkbox"/>	<input type="checkbox"/>	–	–	<input type="checkbox"/>
<input type="checkbox"/>	<input type="checkbox"/>	–	<input type="checkbox"/>	<input type="checkbox"/>
<input type="checkbox"/>	<input type="checkbox"/>	<input type="checkbox"/>	<input type="checkbox"/>	<input type="checkbox"/>
<input type="checkbox"/>	<input type="checkbox"/>	<input type="checkbox"/>	<input type="checkbox"/>	<input type="checkbox"/>
<input type="checkbox"/>	<input type="checkbox"/>	<input type="checkbox"/>	<input type="checkbox"/>	<input type="checkbox"/>



Rear harrow

Levelling tines

**Depth wheels
10/75-15.3 / 260/70-15.3**

Tine protection

**Warning signs
with Lighting**

<input type="checkbox"/>	<input type="checkbox"/>	–	<input type="checkbox"/>	<input type="checkbox"/>
<input type="checkbox"/>	<input type="checkbox"/>	–	<input type="checkbox"/>	<input type="checkbox"/>
<input type="checkbox"/>	<input type="checkbox"/>	<input type="checkbox"/> 10/75-15.3	<input type="checkbox"/>	<input type="checkbox"/>
<input type="checkbox"/>	<input type="checkbox"/>	<input type="checkbox"/> 10/75-15.3	<input type="checkbox"/>	<input type="checkbox"/>
–	–	<input type="checkbox"/> 260/70-15.3	<input type="checkbox"/>	■
–	–	<input type="checkbox"/> 260/70-15.3	<input type="checkbox"/>	■
–	–	<input type="checkbox"/> 260/70-15.3	<input type="checkbox"/>	■

More equipment options

MULTILINE equipment for SYNKRO 3030

Duck foot tine with quick-change for three-row SYNKRO

Narrow tine with quick-change for three-row SYNKRO

Telescopic drawbar for trailed SYNKRO

Dual-circuit air brake system for trailed SYNKRO

Hydraulic brake system for trailed SYNKRO



Your machine goes online.

All the information on your machine
easily – anytime – anywhere

Simply scan the QR code on the **data plate** with your smartphone or tablet or enter your machine number at www.poettinger.at/poetpro. You will immediately receive all the information on your machine.

- Operating instructions
- Optional equipment information
- Brochures
- Photos and videos



PÖTTINGER Spare parts service

- Worldwide network of sales and service partners.
- Decades of spare and wear parts availability.
- Original PÖTTINGER parts can be ordered online around the clock.

Alois PÖTTINGER Maschinenfabrik GmbH

Industriegelände 1
4710 Grieskirchen
Austria
Phone +43 7248 600-0
Fax +43 7248 600-2511
info@poettinger.at
www.poettinger.at

Alois PÖTTINGER UK Ltd.

15 St Marks Road, Corby
Northamptonshire,
NN18 8AN
United Kingdom
Phone + 44 1536 272 220
info.uk@pottingeruk.co.uk
www.pottingeruk.co.uk

POETTINGER Canada Inc.

650, Route 112
St-Cesaire, PQ J0L 1T0
Canada
Phone +1 450 469 5594
Fax +1 866 417 1683
sales.canada@poettinger.ca
www.poettinger.ca

POETTINGER US, Inc.

393 Pilot Drive
Valparaiso, IN 46383
USA
Phone +1 219 510-5534
Fax + 1 219 707-5412
sales.us@poettinger.us
www.poettinger.us

POETTINGER Australia PTY LTD

15 Fordson Road
Campbellfield, VIC 3061
Australia
Phone +61 3 9359 2969
sales.au@poettinger.com.au
www.poettinger.com.au

POETTINGER Ireland Ltd.

Industrial Estate
Cashel Rd., Clonmel, Co. Tipperary
Ireland
Phone +353 52 6125766
info.ie@poettinger.at
www.poettinger.ie

Importer for New Zealand:

Origin Agroup

PO Box 673, 57 Hautapu Road
Cambridge
New Zealand
Phone +64 7 823 7582
info@originagroup.co.nz
www.originagroup.co.nz

Importer for South Africa:

VALTRAC

Cnr. Water & Buiten Street
9585 Parys
South Africa
Phone +27 56 817 7338 7308
wynn@valtrac.co.za
www.valtrac.co.za

